

BODET Scorepad



User manual - Water polo



www.bodet-sport.com

BODET SA
1 rue du Général de Gaulle
49340 Trémentines | FRANCE
Tel: +33 (0)2 41 71 72 33



100% papier recyclé



Ref.: 607951 B

Ensure on delivery that the product has not been damaged in transport.

1. Water Polo

1) Select



2) Select a configuration from the list:

WATER POLO National (Number period: 1 - Time period: 8:00 - Individual fouls: 3)

WATER POLO 1 (Number period: 4 - Time period: 8:00 - Individual fouls: 0)

WATER POLO 2 (Number period: 4 - Time period: 7:00 - Individual fouls: 0)

Configurations identified by can only be edited with the club access code. The club Access code is "1234". It can be changed in the "Club access" menu.



3) Screen in WATER POLO National:



Pressing a game setting brings up a new window in which you can:

- 1 edit the length of each period. The buzzer can be triggered at each end of period and the timer reset.
- 2 edit colour of team shirts and game markings. Standard colours are provided plus a palette to select each team's colours.
- 3 assign an individual foul to a player. A correction function lets you edit the number of fouls and each team's total points.
- 4 edit the name of the team. After pressing LOCALS or VISITORS, press Config. team to edit the configuration of the teams (edit team screen name, activate players, choice of colours, load a team, create a new team or delete a team):



- 5 add a penalty to a player: penalty of 20 minutes.
- 6 call a time-out. To start the countdown, press the **START**  button. Add or delete a time-out by pressing **Correct** .
- 7 add or delete a point from the team score.
- 8 add a goal to team.
- 9 modify or delete one penalty in progress.
- 10 edit the configuration settings (see next page for the list of settings).
- 10 display message outside game periods.
- 10 go to the next period.
- 11 start a new match. **Caution: the match in progress will be lost.**

> Time-out Remote Control System

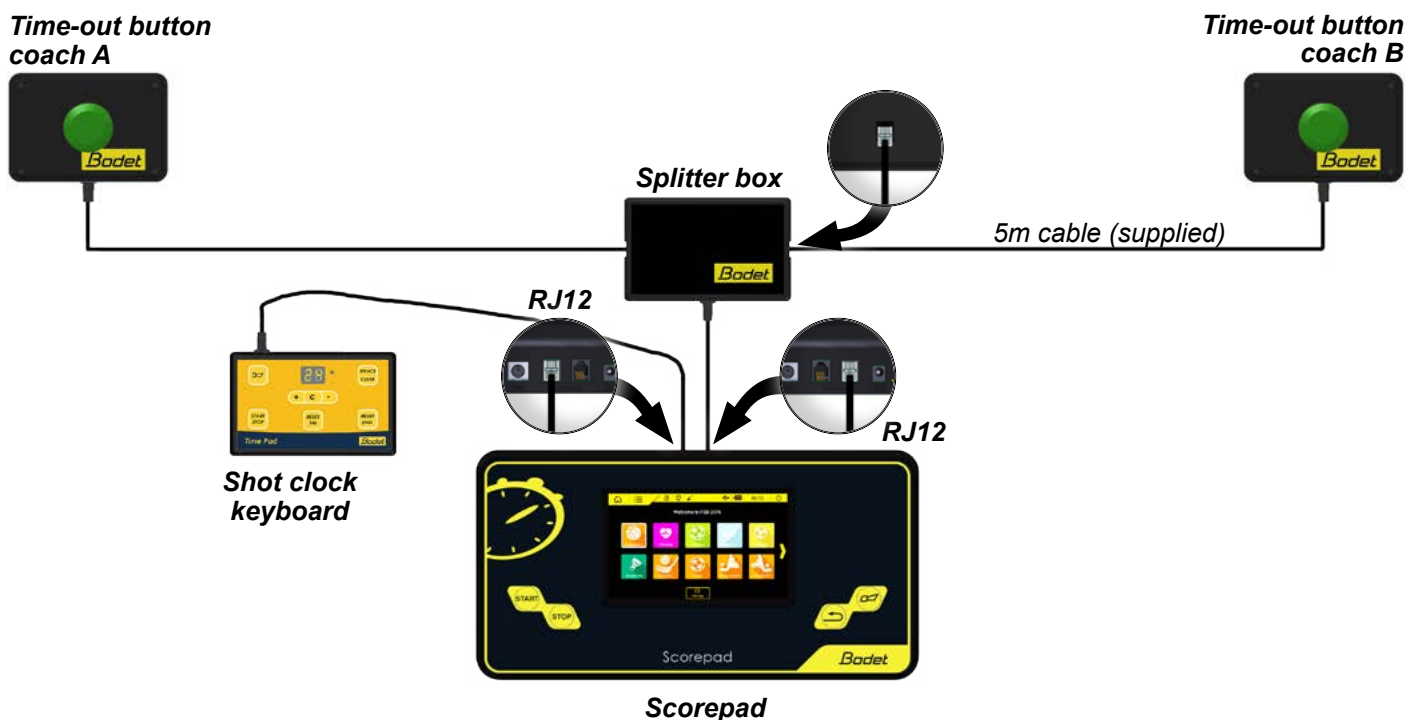

- > This equipment enables the coach of each team to call a time-out during the match.
- > The remote control system operates in parallel with the Scorepad keyboard: the activation of the time-out can be done from the time-out buttons or directly on the Scorepad keyboard.

> ENTERING CONFIGURATION SETTINGS

1) Click  to edit a configuration.

Note: All these settings are accessible from the  **Advanced Settings** menu.

The list of editable settings is given below:

Headings	Settings	Default values	Description	Standard settings
Before match				
	Buzzer before match	OFF	Activation of the pre-end horn with the ON/OFF key 0 to 90 minutes in steps of 1	√
		OFF	0 to 59 seconds in steps of 1	
	Before match duration	OFF	Activation of the end horn with the ON/OFF key 1 to 180 minutes in steps of 1	√
Match				
	Period number	4	1 to 9 periods in steps of 1	√
	Period time	8:00	0 to 90 minutes in steps of 1 0 to 59 seconds in steps of 1	√
	Period mode	Down	Count-up or countdown	√
	End of period buzzer	5s	Function enabled using the ON/OFF button 1 to 5 seconds in steps of 1	√
	Period reset	60s	Function enabled using the ON/OFF button 1 to 300 seconds in steps of 1	√
Time-out				
	Time-out buzzer	OFF	Buzzer duration to signal a rest period Function enabled using the ON/OFF button	√
		OFF	1 to 300 seconds in steps of 1 Possibility to activate a horn for the end of the rest period	
	Time inter period buzzer	OFF	Activation of the pre-end horn with the ON/OFF key 0 to 30 seconds in steps of 1	√
		OFF	Activation of the end horn with the ON/OFF key	
	Half time duration	5:00	Function enabled using the ON/OFF button 0 to 90 minutes in steps of 1 1 to 59 seconds in steps of 1	√
	Time inter period (rest time between each play period)	2:00	Function enabled using the ON/OFF button 0 to 90 minutes in steps of 1 1 to 59 seconds in steps of 1	√
Possession				
	Possession time	30s	Function enabled using the ON/OFF button 1 to 90 seconds in steps of 1	√
	Buzzer	3s	Buzzer duration to signal the end of a possession or attack time Function enabled using the ON/OFF button 1 to 5 seconds in steps of 1	√
	Stop chrono auto	OFF	Activation or deactivation from the club code	√
	Display keyboard	ON	Display on the keyboard of the possession time	√
Points and Penalties				
	Activation penalties	ON	Activation or deactivation from the club code	√
	Penalty duration	OFF	1 to 90 seconds in steps of 1	√
	Display player no.	OFF	Activation or deactivation from the club code	√
	Selection mode	List of players	List of players or keyboard	√
	End of penalty buzzer duration	OFF	Function enabled using the ON/OFF button	√
	Individual fouls	3	Function enabled using the ON/OFF button 1 to 9 Individual fouls	

Time-out				
Buzzer TM	15s ON OFF	Activation of the pre-end horn with the ON/OFF key 1 to 20 seconds in steps of 1 Activation of the end horn with the ON/OFF key Activation of the start horn with the ON/OFF key		√
Indicator TM	60s Number: 1 Period	Function enabled using the ON/OFF button Indicators number TM 1 to 6 in steps of 1 Display time: Minutes: 0 or 1. Seconds : 0 to 59. Reset TM by period or half-time or inactive.		√
Miscellaneous				
Maintain result	10s	Function enabled using the ON/OFF button 1 to 90 seconds in steps of 1		-
HDMI				
HDMI display	...	Choice of HDMI display with player or default.		√
Logo partner	OFF	Choice of partner logos.		√
Load image	...	Enabling wallpaper image (if OFF = wallpaper black)		√
Logo team	ON	Function enabled using the ON/OFF button		√
Function keys				
Alpha message	ON	Function enabled using the ON/OFF button		√
Next period	ON	Function enabled using the ON/OFF button		√